

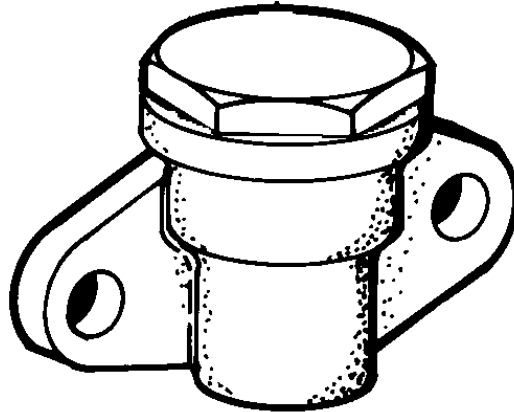

**FLANGE MOUNTED RUBBER  
SEATED CHECK VALVE**

**PARTS CATALOG**



## COMBINED DIRT COLLECTOR AND CUT-OUT COCK

Approximate Net Weight  
3/4 Lbs.

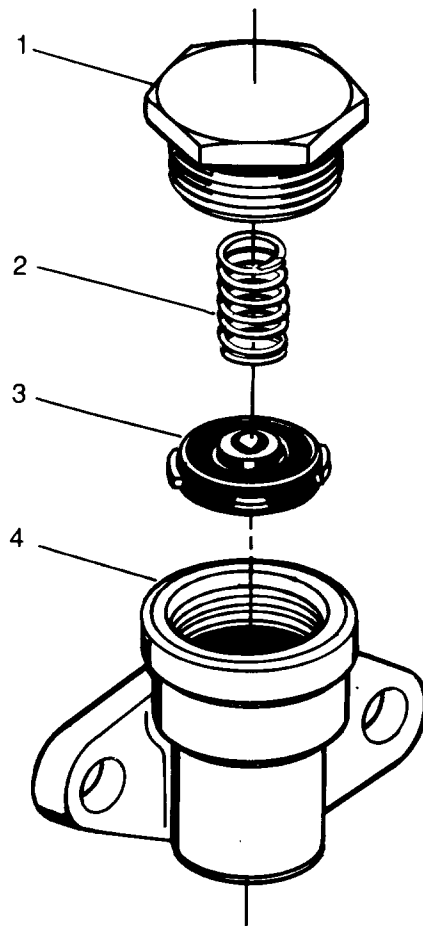

Figure 1



## COMBINED DIRT COLLECTOR AND CUT-OUT COCK

FIG. & INDEX	REPL. PLAN	PART NO.	DRAW NO.	NO. REQ'D.	DESCRIPTION
1-		704799	N-9298		FLANGE MOUNTED, RUBBER SEATED CHECK VALVE
1	C	735332	DC-999	1	. NUT, Cap
2	B	735331	DC-993	1	. SPRING
3	B	50646	CR-1850	1	. VALVE, Check
4	C	735483	DC-1160-C	1	. BODY
*5	A	738764	EV-5423	2	. GASKET, 3/4" O.D. Ring

**Replacement Plan:**

- A = 100% Replacement at every scheduled overhaul.
- B = Replacement dependent upon condition of part.
- C = Replace if damaged during repair, maintenance or overhaul.

**\*NOTE - Not included in assembly.  
Listed for Convenience**

